

SABA S0 SIDEBOARD

SABA S0 SBS2CV – SBS4CV SIDEBOARD

Design;	Faruk Malhan
Materials & Finishes;	<p>a- Carcass; 16mm MDF panel finished in anthracite lacquer. At each compartment, there is a drawer and a shelf in 25mm MDF with lacquer.</p> <p>b- Legs; Solid wood with natural transparent lacquer finish.</p> <p>c- Doors in Veneer; 16mm MDF with natural veneer.</p> <p>d- Doors in Glass; 6mm smoked glass with partial paint on the surface applied on the aluminum frame behind.</p> <p>e- Glass Top panel; 10mm smoked tempered glass.</p> <p>f- Top Panel; 5mm Marble + 5mm composite panel.</p>
Assembly;	<p>a- Carcass assembled with dowels and bushings.</p> <p>b- All other connections with dowels and metric screws.</p>
Warning;	a- Acidic materials such as lemon and vinegar may harm the Marble surface.

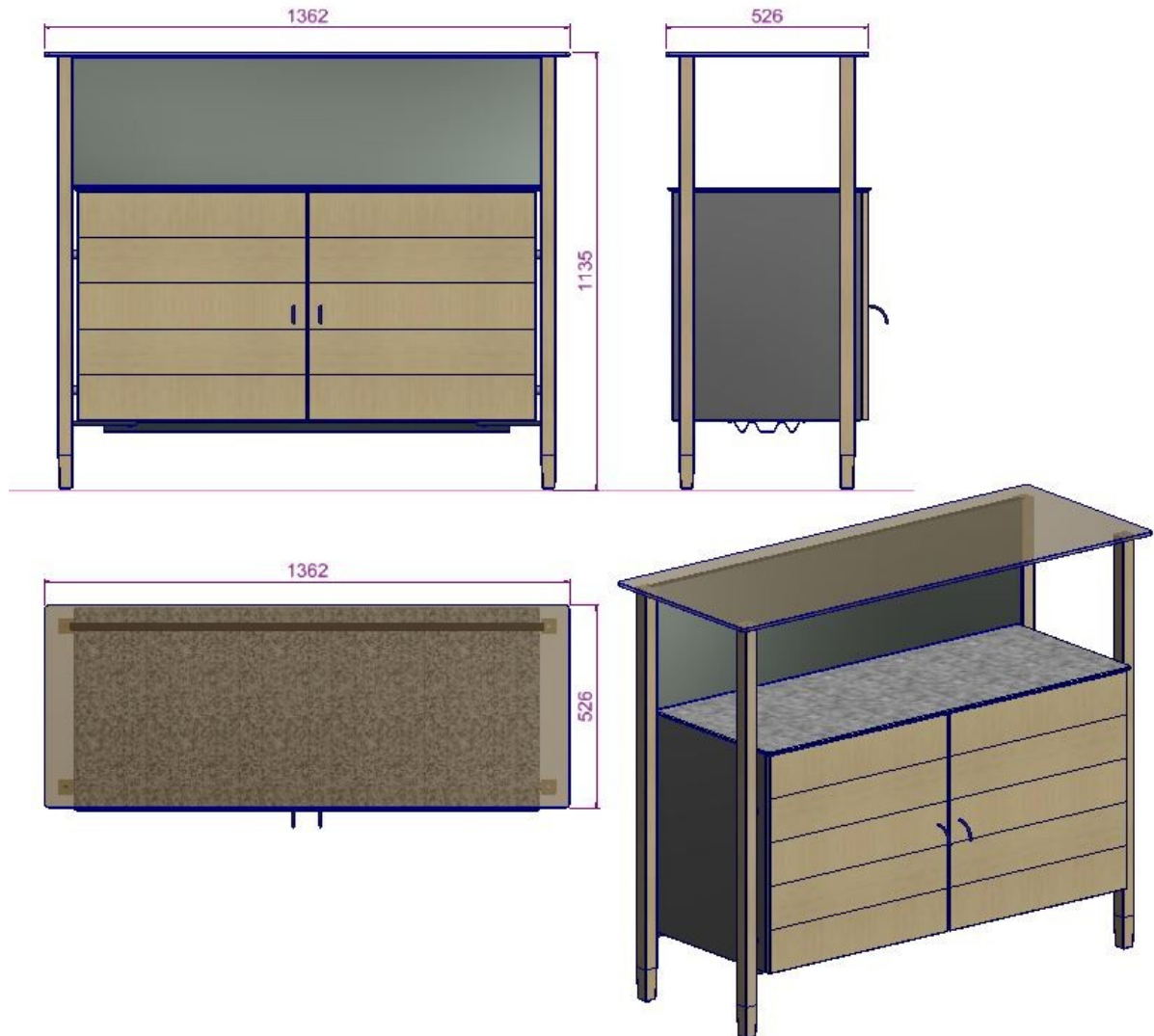

SABA S0 SIDEBOARD

SABA S0 SBS2CV

L:1362 D:526 H:1135 mm



SABA S0 SBS4CV

L:2552 D:526 H:1145 mm

SABA S0 SBS2CG – SBS4CG SIDEBOARD

Design;	Faruk Malhan
Materials & Finishes;	<p>g- Carcass; 16mm melamine board with 1mm ABS edgebanding finished in lacquer.</p> <p>h- Legs; Ash solid wood with natural transparent lacquer finish.</p> <p>i- Doors; 6mm tempered glass with paint on one side.</p> <p>j- Drawer Carcass 12mm MDF wrapped with matt finished folio.</p> <p>k- Drawer Front Panel; 16mm MDF with natural veneer.</p> <p>l- Drawer bottom Panel; 8mm melamine board finished in lacquer.</p> <p>m- Glass Top panel; 10mm smoked tempered glass.</p> <p>n- Top Panel; 5mm Marble + 5mm komposite panel.</p>
Assembly;	

SABA S0 SIDEBORD

	c- Carcass assembled with dowels and bushings. d- All other connections with dowels and metric screws.
Uyarı;	a- Asit İçeren Maddeler (Limon, Sirke Vs.) Mermer Yüzeyine Zarar Verir.

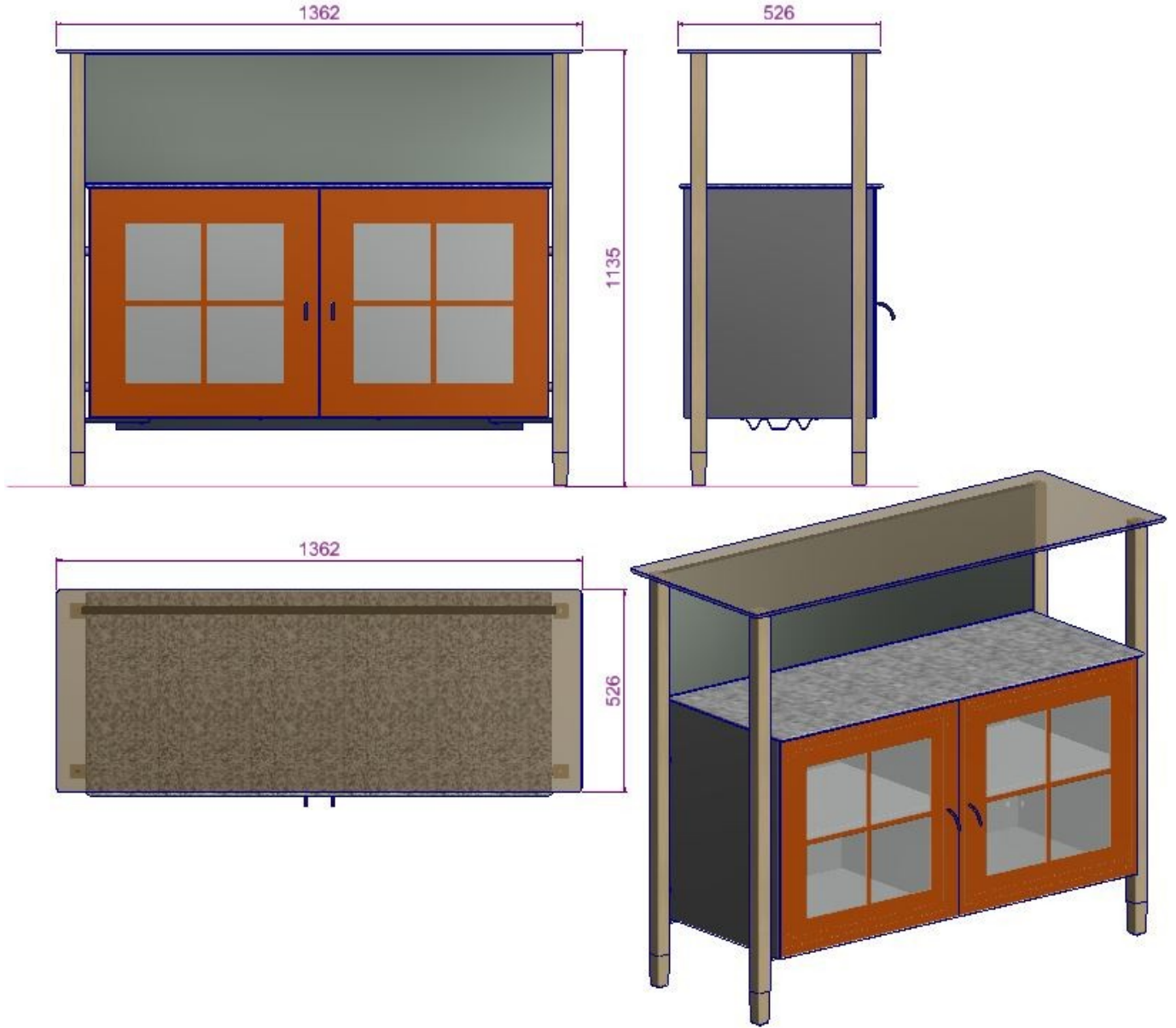

SABA S0 SBS2CG

L:1362 D:526 H:1135 mm

SABA S0 SIDEBOARD



SABA S0 SBS4CG

L:2552 D:526 H:1145 mm